



Outperform every day.™

Project:

Item Number:

Quantity:

Standard Refrigerated Cold Pan Drop-ins

The Vollrath Company, L.L.C.

STANDARD REFRIGERATED COLD PAN DROP-INS



DESCRIPTION

Vollrath's Standard Refrigerated Cold Pans hold pre-chilled food at proper serving temperature.

Refrigerated cold drop-ins are best used for holding periods up to 4 hours. For best performance, stainless steel containers are recommended.

Modular drop-ins cannot be canceled or returned.

False Bottom Options

Optional perforated false bottom is nominal 1" (2.5 cm) high and constructed of 18-gauge 300 series stainless steel. False bottom will reduce well depth by 1 inch.

False Bottom Item No.	Fits Drop-In Item No.
<input type="checkbox"/> 70100	36490
<input type="checkbox"/> 36913-2	36441
<input type="checkbox"/> 36914-2	36442
<input type="checkbox"/> 36915-2	36444
<input type="checkbox"/> 36916-2	36446
<input type="checkbox"/> 98855-2	36448

Agency Listings



Note: Product has not been performance tested for potentially hazardous foods.

Due to continued product improvement, please consult www.vollrath.com for current product specifications.

ITEMS

Item No.	Description	Item No.	Description
36490	One Pan	36444	Four Pan
36441	Two Pan	36446	Five Pan
36442	Three Pan	36448	Six Pan

FEATURES

- Top is 18-gauge stainless steel with seamless well
- Molded breaker gasket fitted under drip edge
- Flat work surface around opening
- A full-perimeter drip edge contains spills and condensation within the stainless steel countertop area of the drop-in
- The deep well is designed to accommodate standard 12" x 20" (30.5 x 50.8 cm) pans with adaptor bars
- 1" (2.5 cm) integral drain
- Refrigeration coils surround the exterior side walls of well for maximum cooling
- High-density polyurethane foam insulation surrounds the exterior of the well to provide the most efficient performance and energy savings
- Condensing unit suspended below well
- Temperature control on compressor
- Exterior housing is 18-gauge galvanized steel
- 6 ft. (183 cm) cord with plug, does not require hard wiring
- On/Off switch is mounted on side of compressor housing
- Positioning clips provided to center drop-in within cutout
- Designed for top-mount installation
- Refrigerant is R134A to meet federal standards

WARRANTY

All models shown come with Vollrath's standard warranty against defects in materials and workmanship. For full warranty details, please refer to www.Vollrath.com.

CLEARANCE REQUIREMENTS

- Zero clearance installation on all sides
- See back page for ventilation requirements

Approvals	Date



Outperform every day.™

www.vollrath.com

The Vollrath Company, L.L.C.

1236 North 18th Street
Sheboygan, WI 53081-3201 U.S.A.
Main Tel: 800.624.2051 or 920.457.4851
Main Fax: 800.752.5620 or 920.459.6573
Customer Service: 800.628.0830
Canada Customer Service: 800.695.8560

Technical Services
techservicereps@vollrathco.com
Induction Products: 800.825.6036
Countertop Warming Products: 800.354.1970
All Other Products: 800.628.0832

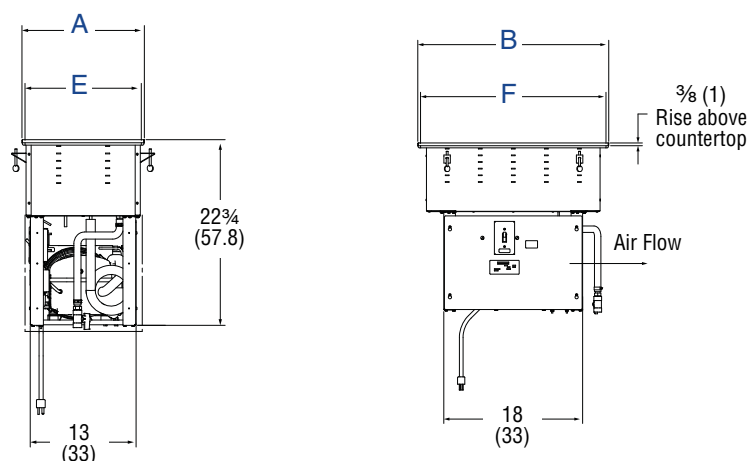
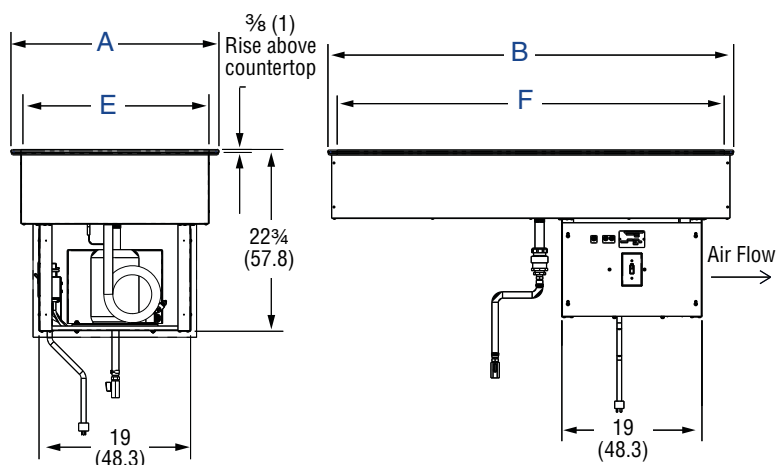
STANDARD REFRIGERATED COLD PAN DROP-INS**DIMENSIONS** (Shown in inches (cm))**One Pan****Two - Six Pan****VENTING REQUIREMENTS**

Customer supplied louvers must be installed in surrounding cabinet to ensure adequate ventilation. One intake and one discharge louver are required. Preferred louver location is the short ends of the cabinet.

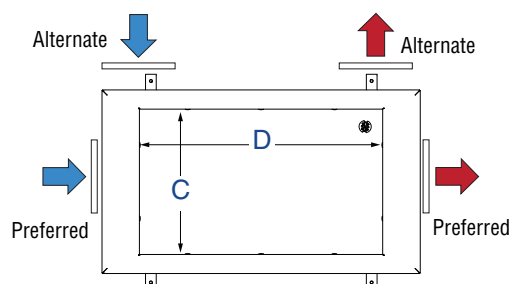
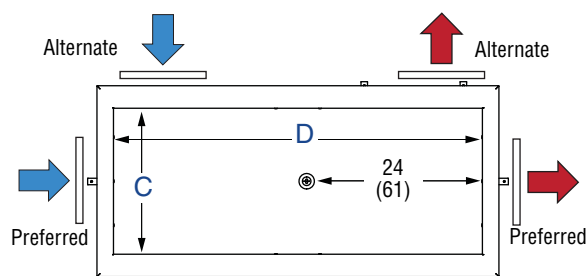
One and Two Pan**Three - Six Pan****SPECIFICATIONS**

Item No.	Pan Size	Overall		Inner		Cutout*		Compressor (HP)	Voltage	Amps	Plug
		A	B	C	D	E	F				
36490	One	15 (38.1)	26 (66)	11 ⁷ / ₈ (30.2)	19 ⁷ / ₈ (50.5)	14 ¹ / ₄ (36.2)	25 ¹ / ₄ (64.1)	1/5	120	3.8	NEMA 5-15P
36441	Two	26 (66)	29 (73.7)	19 ⁷ / ₈ (50.5)	24 ³ / ₄ (62.9)	25 ¹ / ₄ (64.1)	28 ¹ / ₄ (71.8)				
36442	Three		41 ¹ / ₂ (105.4)		37 ¹ / ₂ (95.3)		40 ³ / ₄ (103.5)				
36444	Four		54 ³ / ₄ (139.1)		50 ¹ / ₄ (127.6)		54 (137.2)	1/4			
36446	Five		68 (172.7)		63 (160)		67 ¹ / ₄ (170.8)				
36448	Six		81 ¹ / ₄ (206.4)		75 ³ / ₄ (192.4)		80 ¹ / ₂ (204.5)	1/3		7.2	NEMA 5-20P

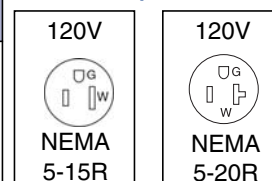
Receptacles

Outperform every day.™

www.vollrath.com

The Vollrath Company, L.L.C.

1236 North 18th Street
Sheboygan, WI 53081-3201 U.S.A.
Main Tel: 800.624.2051 or 920.457.4851
Main Fax: 800.752.5620 or 920.459.6573
Customer Service: 800.628.0830
Canada Customer Service: 800.695.8560

Technical Services
techservice@vollrathco.com
Induction Products: 800.825.6036
Countertop Warming Products: 800.354.1970
All Other Products: 800.628.0832